

FED. ROAD DIST. NO.	STATE	PROJECT NO.	FISCAL YEAR	SHEET NO.	TOTAL SHEETS
3	OKLA.	HSIPG-215F(027)TR	2017	1	9

DESCRIPTION	REVISIONS	DATE
△ REV. PROJECT INFO, SHEET NUMBERS & LOCATION LETTERS		09-14-17

STATE OF OKLAHOMA  
DEPARTMENT OF TRANSPORTATION

PLAN OF PROPOSED  
**STATE HIGHWAY**  
PROJECT NO. HSIPG-215F(027)TR  
SAFETY IMPROVEMENT

△ US-75, SH-19, SH-18, SH-66, SH-74, SH-76, US-270, SH-99 & US-177

**COAL, GARVIN, LINCOLN,  
MCCLAIN, POTTAWATOMIE  
& SEMINOLE COUNTIES**

△ CONTROL SECTION NO. : 75-15-02, 19-25-10, 18-41-16, 66-41-08, 74-44-32, 74-44-34, 76-44-44, 270-63-12, 99-63-36, 18-63-26, 177-63-20, 270-67-12

STATE JOB NO. 33294(04)

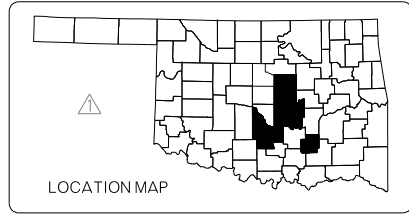

INDEX OF SHEETS

SHEET NUMBER	SHEET DESCRIPTION
0001	TITLE SHEET
AT01	SUMMARY OF PAY QUANTITIES & NOTES
T001	PROJECT LOCATION COAL COUNTY
T002	PROJECT LOCATION GARVIN COUNTY
T003	PROJECT LOCATION LINCOLN COUNTY
T004	PROJECT LOCATION MCCLAIN COUNTY
△ T005	PROJECT LOCATION POTTAWATOMIE COUNTY
△ T006	PROJECT LOCATION SEMINOLE COUNTY
△ T007	TRAFFIC CONTROL DETAIL

STANDARDS TO BE INCLUDED

TRAFFIC

PM3-1-02	TCS7-1-02
RS2-2-00	TCS8-1-00
TCS1-1-01	TCS9-1-01
TCS2-1-00	TCS11-1-01
TCS3-1-01	TCS14-1-00
TCS4-1-01	TCS19-1-01
TCS5-1-00	TCS20-1-00
TCS6-1-02	

OKLAHOMA DEPARTMENT OF TRANSPORTATION  
 ENGINEER MANAGER: TAREK A. MAAROUF CHECKED BY: TAREK A. MAAROUF PROJECT ENGINEER: K. DEDERING  
 ENGINEER INTERN: G. FADEL SQUAD SUPERVISOR: B. ABRAHAM SQUAD MEMBERS: J. FOX, A. POLACH, I. SHIELDS, C. DIVIS

CONVENTIONAL SYMBOLS

- PROPOSED ROAD
- RAILROADS
- RANGE & TOWNSHIP
- SECTION LINES
- QUARTER SECTION LINES
- FENCES
- GROUND LINE
- EXISTING ROADS
- BASE LINE
- GRADE LINES
- TELEPHONE & TELEGRAPH
- POWER LINES
- BUILDINGS
- OILWELL
- DRAINAGE STRUCTURES - IN PLACE
- DRAINAGE STRUCTURES - NEW
- RIGHT-OF-WAY LINES - EXISTING
- RIGHT-OF-WAY LINES - NEW
- CONTROLLED ACCESS
- RIGHT-OF-WAY FENCE

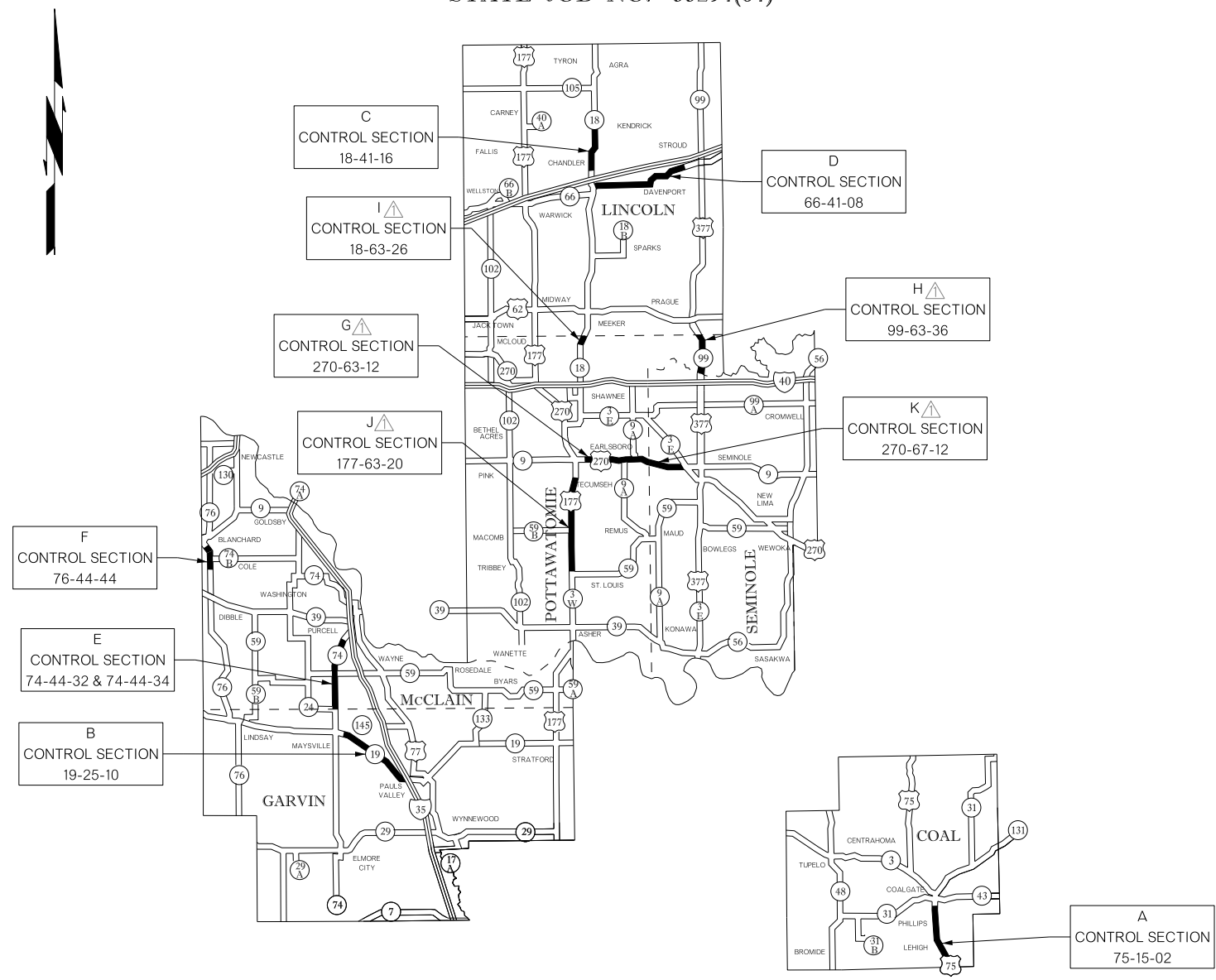

2009 OKLAHOMA STANDARD SPECIFICATIONS FOR HIGHWAY CONSTRUCTION GOVERN, APPROVED BY THE U.S. DEPARTMENT OF TRANSPORTATION, FEDERAL HIGHWAY ADMINISTRATION, JANUARY 4, 2010.

PREPARED BY:  
OKLAHOMA DEPARTMENT OF TRANSPORTATION  
TRAFFIC ENGINEERING DIVISION

DATE 09-14-17

OKLA. REG. NO. 25181

OKLAHOMA DEPARTMENT OF TRANSPORTATION	DEPARTMENT OF TRANSPORTATION FEDERAL HIGHWAY ADMINISTRATION
DATE APPROVED _____	DATE APPROVED _____
BY _____ CHIEF ENGINEER	BY _____ DIVISION ADMINISTRATOR
SWO _____	PROJECT NO. HSIPG-215F(027)TR
COUNTY MULTI-COUNTIES	HIGHWAY MULTI-HIGHWAY SHEET NO. 0001

P.E. NO. : XXXXX(01)

**TRAFFIC GENERAL CONSTRUCTION NOTES**

EXISTING ROADWAY SHALL REMAIN OPEN DURING CONSTRUCTION. THE CONTRACTOR SHALL BE RESPONSIBLE FOR PROPER BARRICADES, LIGHTS, AND SIGNING WITHIN THE LIMITS OF CONSTRUCTION. ALL CONSTRUCTION SIGNING WILL BE IMPLEMENTED ACCORDING TO CONSTRUCTION PLANS. CONSTRUCTION TRAFFIC CONTROL WILL BE INSTALLED IN A MANNER APPROVED BY THE ENGINEER, IN ACCORDANCE WITH CHAPTER VI OF THE MANUAL ON UNIFORM TRAFFIC CONTROL DEVICES, (CURRENT EDITION), AND COMPLIANT WITH APPLICABLE O.D.O.T. STANDARD DRAWINGS.

THIS PROJECT SHALL BE CONSTRUCTED WITHOUT CLOSING TRAFFIC ON CROSS STREETS. A MINIMUM OF ONE LANE IN EACH DIRECTION SHALL BE MAINTAINED AT ALL TIMES.

THE CONTRACTOR SHALL PROVIDE A PERSON TO BE ON 24 HOUR CALL AS NEEDED AS DETERMINED BY THE ENGINEER. THIS PERSON SHALL HOLD A CURRENT CERTIFICATION FROM THE AMERICAN TRAFFIC SAFETY SERVICE ASSOCIATION (ATSSA) OR THE OKLAHOMA TRAFFIC ENGINEERING ASSOCIATION (OETA) AS A TRAFFIC CONTROL TECHNICIAN OR TRAFFIC CONTROL SUPERVISOR.

ALL TEMPORARY TRAFFIC CONTROL DEVICES SHALL MEET ODOT'S "QUALITY STANDARDS FOR TEMPORARY TRAFFIC CONTROL DEVICES." CHANNELIZING DEVICES SHALL HAVE A MINIMUM HEIGHT OF 36 INCHES. THE CONTRACTOR SHALL BE RESPONSIBLE FOR THE MAINTENANCE OF THE TEMPORARY TRAFFIC CONTROL DEVICES, AND SHALL BE RESPONSIBLE FOR REPAIRING OR REPLACING ANY DEVICES DURING CONSTRUCTION.

(SP-1)

**SPECIAL PAY QUANTITY NOTES**

(SP-2) PORTABLE CHANGEABLE MESSAGE SIGN TO BE PLACED WHERE DEEMED NECESSARY BY THE ENGINEER.

(SP-3) INCLUDED WITH THIS PAY ITEM IS THE INSTALLATION OF ANY TEMPORARY PAVEMENT MARKING WHEN REQUIRED AFTER STRIPE REMOVAL. SEE BOX NOTE ON THIS SHEET.

(SP-4) DISPOSE OF REMOVED MATERIALS IN ACCORDANCE WITH SUBSECTION 104.09, "REMOVAL AND DISPOSAL OF SALVAGED MATERIALS, STRUCTURES, AND OBSTRUCTIONS," COST OF DISPOSAL TO BE INCLUDED IN THIS PAY ITEM.

THIS IS AN ESTIMATED QUANTITY TO BE USED FOR THE CENTER LINE AND IT IS BASED ON DOUBLE YELLOW SOLID. THE CONTRACTOR SHALL COOPERATE WITH THE ENGINEER TO DETERMINE THE PASSING ZONE AREAS ALONG THE PROJECT.

THE CONTRACTOR SHALL NOT START STRIPING UNTIL THE PASSING ZONE AREAS HAVE BEEN DETERMINED AND ARE DEEMED ACCEPTABLE BY THE ENGINEER.

**SIGNING & STRIPING QUANTITY NOTES**

(TS-24) QUANTITY SHOWN INCLUDES 0L.F. TRAFFIC STRIPE(MULTI-POLYMER)(WHITE) AND 749,880 L.F. TRAFFIC STRIPE(MULTI-POLYMER)(YELLOW) AND WILL BE MEASURED BY THE LINEAR FOOT OF FOUR INCH (4") WIDE TRAFFIC STRIPE.

**TRAFFIC PAY QUANTITY NOTES**

(TC-13) A PART, OR ALL, OF THIS ITEM IS INTENDED FOR REPLACEMENT OF REMOVED EXISTING CONFLICTING STRIPING.

(TC-14) SEE STANDARD DRAWING PM1-1, PM2-1, PM3-1, PM4-1, PM5-1, PM6-1, PM7-1, PM8-1 (LATEST REVISION). A PART, OR ALL, OF THE QUANTITY SHOWN IS TO BE USED AS FINAL PAVEMENT MARKING.

(TC-22) AMOUNT SHOWN IS AN APPROXIMATION AND THE ACTUAL AMOUNT OF REMOVAL, IF NECESSARY, SHALL BE DETERMINED BY THE ENGINEER. PRICE BID FOR PAVEMENT MARKING REMOVAL SHALL INCLUDE THE COST OF REMOVING STRIPE, ARROWS, WORDS AND SYMBOLS. AS SHOWN IN THE PLANS. THESE ITEMS MAY CONSIST OF PLASTIC, PAINT OR NON-REMOVABLE MARKING TAPE.

(TC-25) ALL CONSTRUCTION TRAFFIC CONTROL WILL BE IMPLEMENTED ACCORDING TO CONSTRUCTION PLANS, AND INSTALLED IN A MANNER APPROVED BY THE ENGINEER, IN ACCORDANCE WITH CHAPTER VI OF THE MANUAL ON UNIFORM TRAFFIC CONTROL DEVICES, (CURRENT EDITION), AND COMPLIANT WITH APPLICABLE O.D.O.T. STANDARD DRAWINGS. PRICE BID FOR THIS ITEM SHALL BE PAYMENT IN FULL FOR THE INSTALLATION, MAINTENANCE AND SUBSEQUENT REMOVAL OF ALL NECESSARY CONSTRUCTION TRAFFIC CONTROL DEVICES AND PAVEMENT MARKINGS REQUIRED FOR COMPLETION OF THE PROJECT.

ALL SIGNS AND BARRICADES, WHICH ARE SHOWN WITH TYPE 'A' LIGHTS IN THE STANDARD DRAWINGS SHALL HAVE THE CORRESPONDING LIGHT ATTACHED DURING NON-DAYLIGHT HOURS.

(TC-27) WHEN A PILOT CAR IS REQUIRED ON TWO LANE / TWO-WAY ROADWAYS, THE CONTRACTOR SHALL USE A PILOT CAR WITH A LICENSED OPERATOR. THE PILOT CAR OPERATOR SHALL BE IN RADIO CONTACT WITH PERSONNEL IN THE TEMPORARY TRAFFIC CONTROL ZONE. MAXIMUM SPEED OF THE PILOT CAR THROUGH THE WORK ZONE AREA SHALL BE 25 MPH. FULL COMPENSATION FOR FURNISHING AND OPERATING THE PILOT CAR (INCLUDING DRIVER, RADIO, AND ANY OTHER EQUIPMENT OR LABOR REQUIRED) SHALL BE INCLUDED IN THE PRICE BID OF PILOT CAR.

PILOT CAR SHALL BE APPROVED VEHICLE, SHOULD CARRY THE CONTRACTOR'S INSIGNIA, AND BE EQUIPPED WITH SIGNS READING "PILOT CAR—FOLLOW ME" MOUNTED A MINIMUM OF ONE (1) FOOT ABOVE THE TOP OF THE VEHICLE AND CLEARLY VISIBLE FROM BOTH DIRECTIONS.

(TC-52) ANY USED TRUCK MOUNTED ATTENUATOR, AND CHANGEABLE MESSAGE SIGN TO BE PLACED ON THIS PROJECT SHALL BE SUBJECT TO INSPECTION AND APPROVAL, BY THE OKLAHOMA DEPARTMENT OF TRANSPORTATION, TO ASSURE THAT THEY ARE IN GOOD WORKING CONDITION, PRIOR TO PLACEMENT ON THE PROJECT.

(TC-70) THIS ITEM IS AN ESTIMATED QUANTITY TO BE USED AS DEEMED NECESSARY BY THE ENGINEER.

(TC-75) TEMPORARY PAVEMENT MARKINGS SHALL BE IN PLACE THE SAME DAY THAT EXISTING PAVEMENT MARKINGS ARE REMOVED FROM ANY ROADWAY OPEN TO TRAFFIC. ALSO, ALL TEMPORARY PAVEMENT MARKINGS SHALL BE REMOVED PRIOR TO THE INSTALLATION OF FINAL STRIPING.

(TC-76) ANY TRUCK MOUNTED ATTENUATOR USED ON THIS PROJECT SHALL HAVE PASSED ALL MANDATORY AND OPTIONAL TESTS LISTED IN NCHRP 350, TL-3 CRITERIA. THIS ITEM IS TO BE USED WHERE SHOWN IN THE STANDARD DRAWINGS OR AT THE DISCRETION OF THE ENGINEER ON SHADOW VEHICLES PROTECTING THE WORK AREAS AND TEMPORARY ROADSIDE HAZARDS.

(TC-77) TRUCK MOUNTED ATTENUATORS ARE TO BE INSTALLED ON NON-STATE OWNED TRUCKS HAVING A MINIMUM GROSS WEIGHT RATING OF 15,000 POUNDS. EACH OF THESE TRUCKS SHALL ALSO BE EQUIPPED WITH AN ARROW DISPLAY (TYPE B).

(TC-84) 65 CONSTRUCTION CALENDAR DAYS WERE USED TO COMPUTE THE SIGN DAY PAY ITEMS. THE AMOUNT OF CALENDAR DAYS USED TO COMPUTE THE SIGN DAY PAY ITEMS IS AN ESTIMATED QUANTITY ONLY, BASED ON THE CURRENT O.D.O.T. STANDARDS AND SUGGESTED CONSTRUCTION SEQUENCE FOR THIS PROJECT. THESE ESTIMATED SIGN DAY QUANTITIES MAY CHANGE AS THE PROJECT'S CONSTRUCTION TRAFFIC CONTROL IS MODIFIED DURING CONSTRUCTION.

(TC-85) THESE SIGNS MUST BE ON THE OKLAHOMA DEPARTMENT OF TRANSPORTATION LIST OF APPROVED CHANGEABLE MESSAGE SIGNS. FOR A LIST OF THE APPROVED SIGNS GO TO THE OKLAHOMA DEPARTMENT OF TRANSPORTATION WEBSITE AT: <http://www.okladot.state.ok.us/traffic/qpl/index.php>

**PAY QUANTITY SCHEDULE**

0300 TRAFFIC CONTROL

PAY ITEM	CODE NO.		UNIT	QUANTITY
876(A)	8482	(PL) TRUCK MOUNTED ATTENUATOR (TC-52,70,76,77)	SD	130.00
880(I)	8902	FLAGGER (TC-70)	SD	65.00
880(J)	8905	CONSTRUCTION TRAFFIC CONTROL (TC-25)	LSUM	1.00
880(W)	8800	PILOT CAR (TC-27)	LSUM	1.00
882(A)	8306	PORT. CHANGEABLE MESSAGE SIGN (SP-1)(TC-52,84,85)	SD	130.00

**PAY QUANTITY SCHEDULE**

0301 TRAFFIC SIGNING & STRIPING

PAY ITEM	CODE NO.		UNIT	QUANTITY
413(A)	4870	RUMBLE STRIP-CENTERLINE HMA-CON (SP-3)	LF	374,940.00
856(A)	8530	TRAFFIC STRIPE(MULTI-POLYMER)(4" WIDE) (SP-4)(TC-13,14)(TS-24)	LF	749,880.00
857(F)	8006	PAVEMENT MARKING REMOVAL(TRAFFIC STRIPE) (SP-2)(TC-22,70,75)	LF	749,880.00

**PAY QUANTITY SCHEDULE**

0640 CONSTRUCTION

PAY ITEM	CODE NO.		UNIT	QUANTITY
641	1552	MOBILIZATION	LSUM	1.00

IF UNABLE TO INSTALL PERMANENT PAVEMENT MARKINGS IMMEDIATELY AFTER EXISTING PAVEMENT MARKINGS ARE REMOVED OR INSTALLATION OF PERMANENT PAVEMENT MARKINGS IS REQUIRED IN A LOCATION WHERE PRIOR REMOVAL IS NOT NECESSARY; TEMPORARY PAVEMENT MARKINGS THAT CONFORM WITH ODOT STANDARDS AND SPECIFICATIONS SHALL BE INSTALLED AND MAINTAINED FOR A PERIOD NOT TO EXCEED 48 HOURS, AT WHICH TIME NEW PERMANENT PAVEMENT MARKINGS SHALL BE INSTALLED. IF INCLEMENT WEATHER OR OTHER CONDITIONS PROHIBIT THE INSTALLATION OF NEW PAVEMENT MARKINGS WITHIN A TIMELY MANNER, NO PAVEMENT MARKINGS SHOULD BE REMOVED.

\*JP# 33293(04), 33294(04), 33295(04)

ARE MANDATORY TIED PROJECTS CONTRACTOR SHALL COORDINATE TRAFFIC CONTROL PRIOR TO CONSTRUCTION AND AS DEEMED NECESSARY BY THE ENGINEER.

MOBILIZATION AND TRAFFIC CONTROL PAY QUANTITIES SHOWN ON THIS SHEET ARE FOR MANDATORY TIED PROJECTS JP 33293(04), 33294(04) AND 33295(04).

DIVISION 3		MULTIPLE COUNTIES		DETAIL:	TMS	7/17	
SUMMARY OF PAY QUANTITIES & NOTES				CHECK:	GF	7/17	
				ENGINEER:	KCD	7/17	
STATE OF OKLAHOMA				GROUP:	ABRAHAM		
				EM:	MAAROUF		
DEPARTMENT OF TRANSPORTATION		JOB/PIECE NO.	33294(04)		SHEET NO.		AT01

REVISIONS		
REV. NO.	DESCRIPTION	DATE

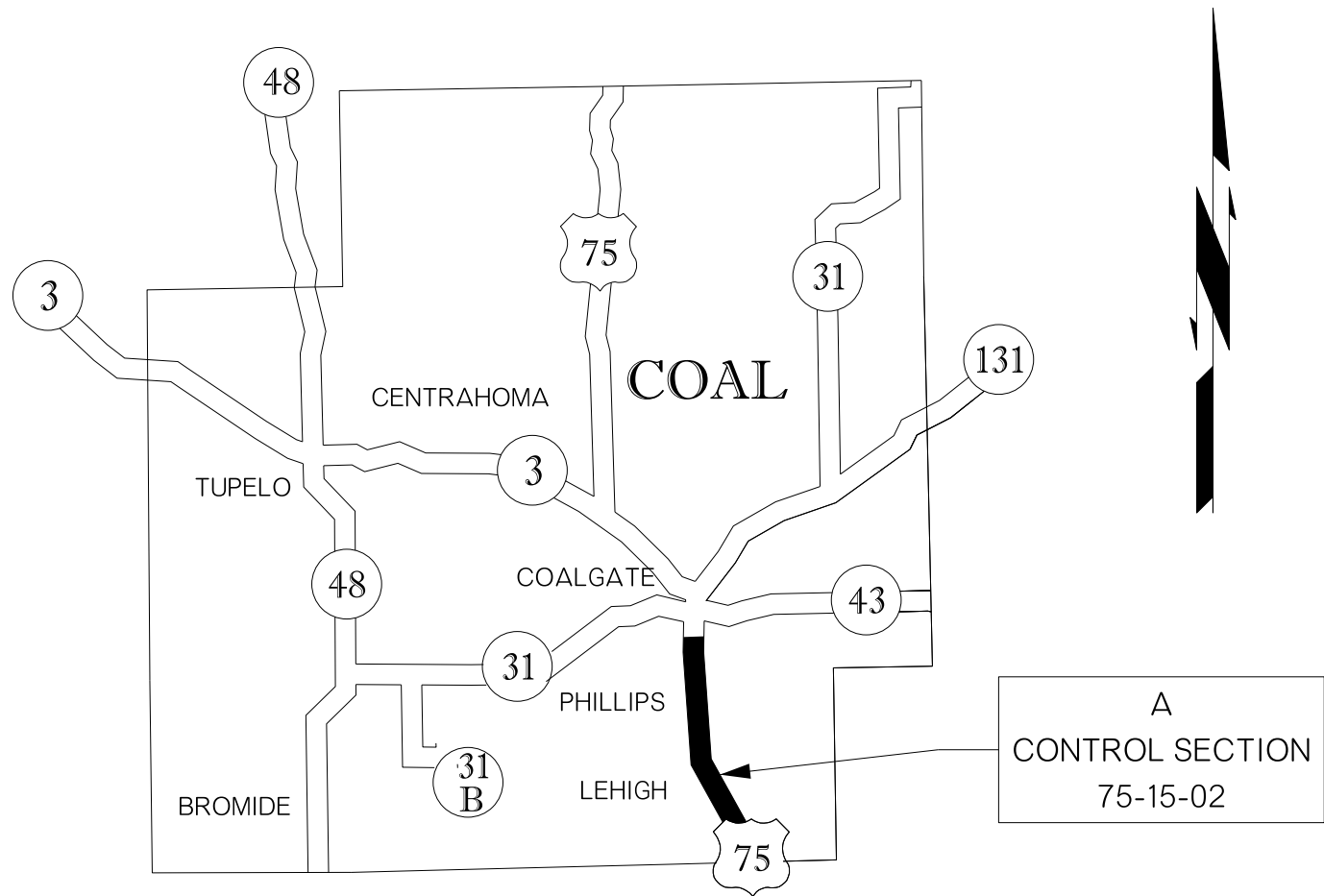

**CONTROL SECTION: 75-15-02**

301 TRAFFIC STRIPING

DESCRIPTION	UNIT	QUANTITY
RUMBLE STRIP-CENTERLINE HMA-CON	LF	39,500.00
TRAFFIC STRIPE (MULTI-POLYMER)(4" WIDE)	LF	79,000.00
PAVEMENT MARKING REMOVAL (TRAFFIC STRIPE)	LF	79,000.00

PROJECT DESCRIPTION      US-75: BEGINNING AT THE ATOKA COUNTY LINE EXTENDING APPROXIMATELY  
LOCATION: A                      7.48 MILES NORTH TO THE CITY OF COALGATE, IN COAL COUNTY.

TOTAL LENGTH- 7.48 MILES

KEY:  
A: ██████████

NOT TO SCALE

DIVISION 3 US-75	COAL COUNTY	DETAIL:	TMS	7/17
		CHECK:	GF	7/17
		ENGINEER:	KCD	7/17
		GROUP:	ABRAHAM EM: MAAROUF	
STATE OF OKLAHOMA		DEPARTMENT OF TRANSPORTATION		
JOB/PIECE NO. 33294(04)		SHEET NO. T001		

REVISIONS		
REV. NO.	DESCRIPTION	DATE

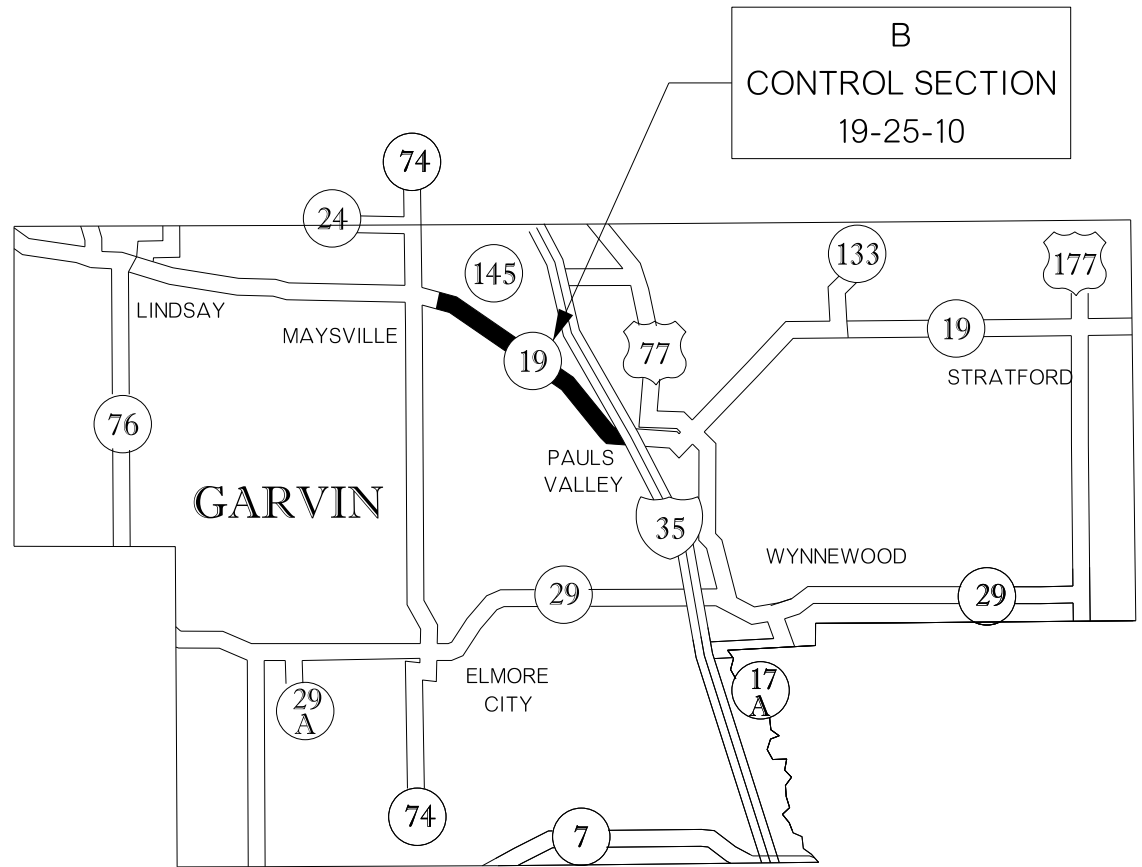

**CONTROL SECTION: 19-25-10**

301 TRAFFIC STRIPING		
DESCRIPTION	UNIT	QUANTITY
RUMBLE STRIP-CENTERLINE HMA-CON	LF	48,480.00
TRAFFIC STRIPE (MULTI-POLYMER)(4" WIDE)	LF	96,960.00
PAVEMENT MARKING REMOVAL (TRAFFIC STRIPE)	LF	96,960.00

PROJECT DESCRIPTION  
LOCATION: B

SH-19: BEGINNING APPROXIMATELY 0.25 MILE EAST OF THE JUNCTION OF SH-74 AND SH-19, IN THE TOWN OF MAYSVILLE EXTENDING EAST APPROXIMATELY 9.18 MILES TO THE CITY OF PAULS VALLEY, IN GARVIN COUNTY.

TOTAL LENGTH- 9.18 MILES

KEY:  
B: ██████████

NOT TO SCALE

DIVISION 3 SH-19	GARVIN COUNTY	DETAIL:	TMS	7/17
PROJECT LOCATION GARVIN COUNTY		CHECK:	GF	7/17
		ENGINEER:	KCD	7/17
		GROUP:	ABRAHAM	
		EM:	MAAROUF	
STATE OF OKLAHOMA	DEPARTMENT OF TRANSPORTATION	JOB/PIECE NO. 33294(04)	SHEET NO. T002	

REVISIONS		
REV. NO.	DESCRIPTION	DATE

C  
CONTROL SECTION  
18-41-16

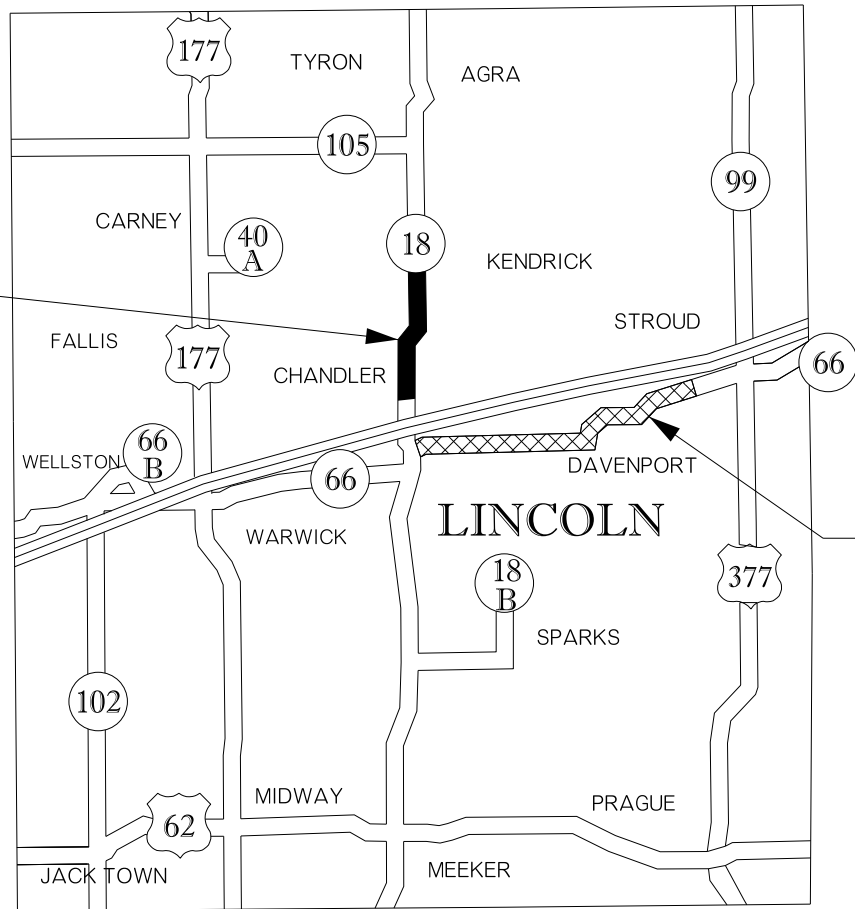

D  
CONTROL SECTION  
66-41-08

CONTROL SECTION: 18-41-16 & 66-41-08		
301 TRAFFIC STRIPING		
DESCRIPTION	UNIT	QUANTITY
RUMBLE STRIP-CENTERLINE HMA-CON	LF	85,800.00
TRAFFIC STRIPE (MULTI-POLYMER)(4" WIDE)	LF	171,600.00
PAVEMENT MARKING REMOVAL (TRAFFIC STRIPE)	LF	171,600.00

PROJECT DESCRIPTION  
LOCATION: C

SH-18: BEGINNING APPROXIMATELY 1.41 MILES NORTH OF THE NORTH JUNCTION OF SH-66 AND SH-18, IN THE CITY OF CHANDLER, EXTENDING NORTH APPROXIMATELY 3.95 MILES, IN LINCOLN COUNTY.

PROJECT DESCRIPTION  
LOCATION: D

SH-66: BEGINNING AT THE SOUTH JUNCTION OF SH-66 AND SH-18, IN THE CITY OF CHANDLER, EXTENDING EAST APPROXIMATELY 12.30 MILES, IN LINCOLN COUNTY.

TOTAL LENGTH- 16.25 MILES

KEY:

C:	
D:	

NOT TO SCALE

DIVISION 3 SH-18 & 66	LINCOLN COUNTY	DETAIL:	TMS	7/17
PROJECT LOCATION LINCOLN COUNTY		CHECK:	GF	7/17
		ENGINEER:	KCD	7/17
STATE OF OKLAHOMA		DEPARTMENT OF TRANSPORTATION	JOB/PIECE NO. 33294(04)	
			SHEET NO. T003	

REVISIONS		
REV. NO.	DESCRIPTION	DATE

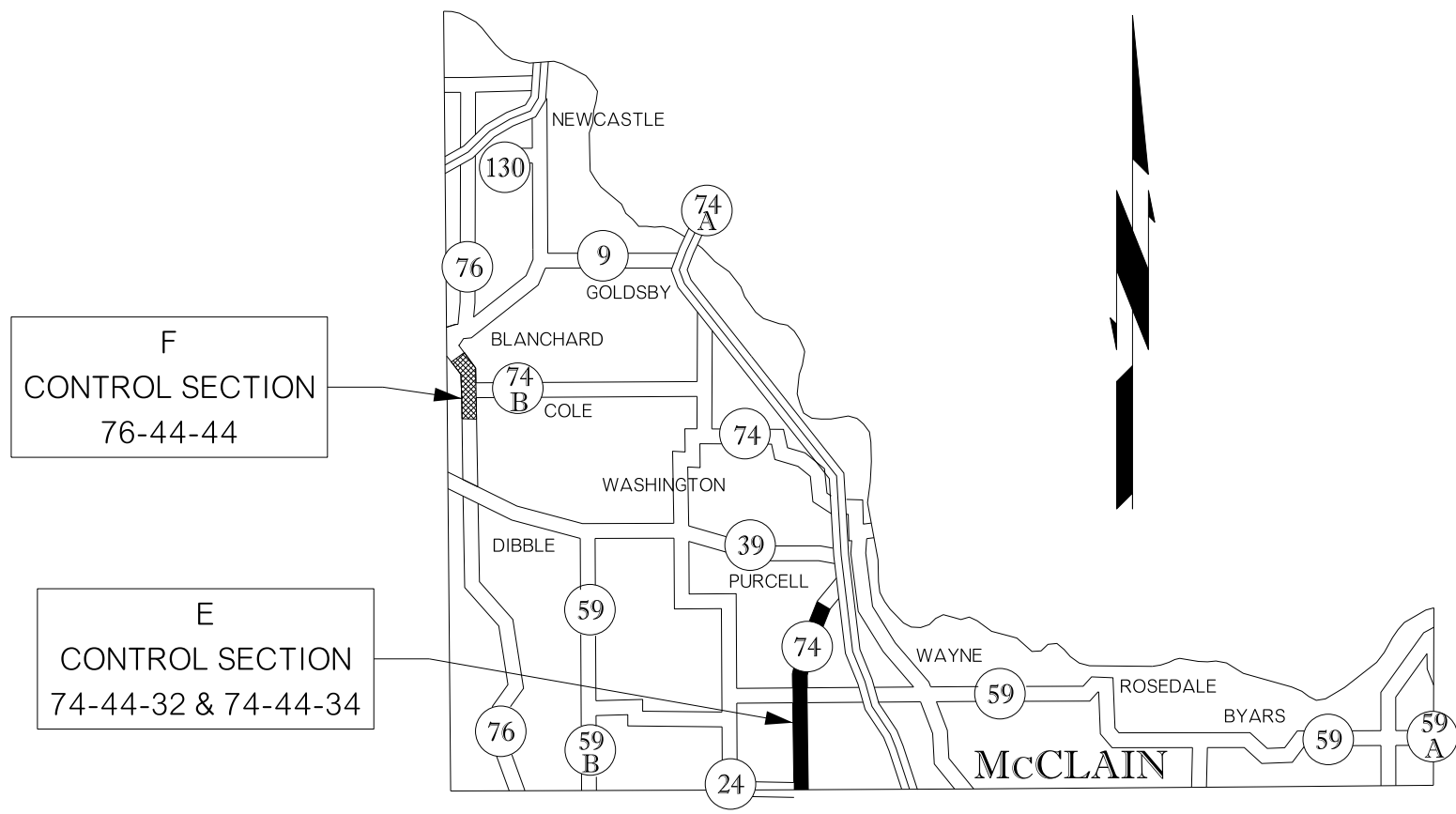

F  
CONTROL SECTION  
76-44-44

E  
CONTROL SECTION  
74-44-32 & 74-44-34

CONTROL SECTION: 74-44-32, 74-44-34 & 76-44-44		
301 TRAFFIC STRIPING		
DESCRIPTION	UNIT	QUANTITY
RUMBLE STRIP-CENTERLINE HMA-CON	LF	55,600.00
TRAFFIC STRIPE (MULTI-POLYMER)(4" WIDE)	LF	111,200.00
PAVEMENT MARKING REMOVAL (TRAFFIC STRIPE)	LF	111,200.00

PROJECT DESCRIPTION LOCATION: E SH-74: BEGINNING AT THE JUNCTION OF SH-24 AND SH-74, ON THE McCLAIN/ GARVIN COUNTY LINE, EXTENDING NORTH APPROXIMATELY 8.26 MILES TO THE CITY OF PURCELL, IN McCLAIN COUNTY.

PROJECT DESCRIPTION LOCATION: F SH-76: BEGINNING APPROXIMATELY 3.07 MILES NORTH OF THE JUNCTION OF SH-39 AND SH-76 EXTENDING NORTH APPROXIMATELY 2.27 MILES TO THE CITY OF BLANCHARD, IN McCLAIN COUNTY.

TOTAL LENGTH- 10.53 MILES

KEY:	
E:	
F:	

NOT TO SCALE

DIVISION 3 SH-74 & 76	McCLAIN COUNTY	DETAIL:	TMS	7/17
PROJECT LOCATION McCLAIN COUNTY		CHECK:	GF	7/17
		ENGINEER:	KCD	7/17
		GROUP:	ABRAHAM	
		EM:	MAAROUF	
STATE OF OKLAHOMA	DEPARTMENT OF TRANSPORTATION	JOB/PIECE NO. 33294(04)	SHEET NO. T004	

△ I  
CONTROL SECTION  
18-63-26

△ G  
CONTROL SECTION  
270-63-12

△ J  
CONTROL SECTION  
177-63-20

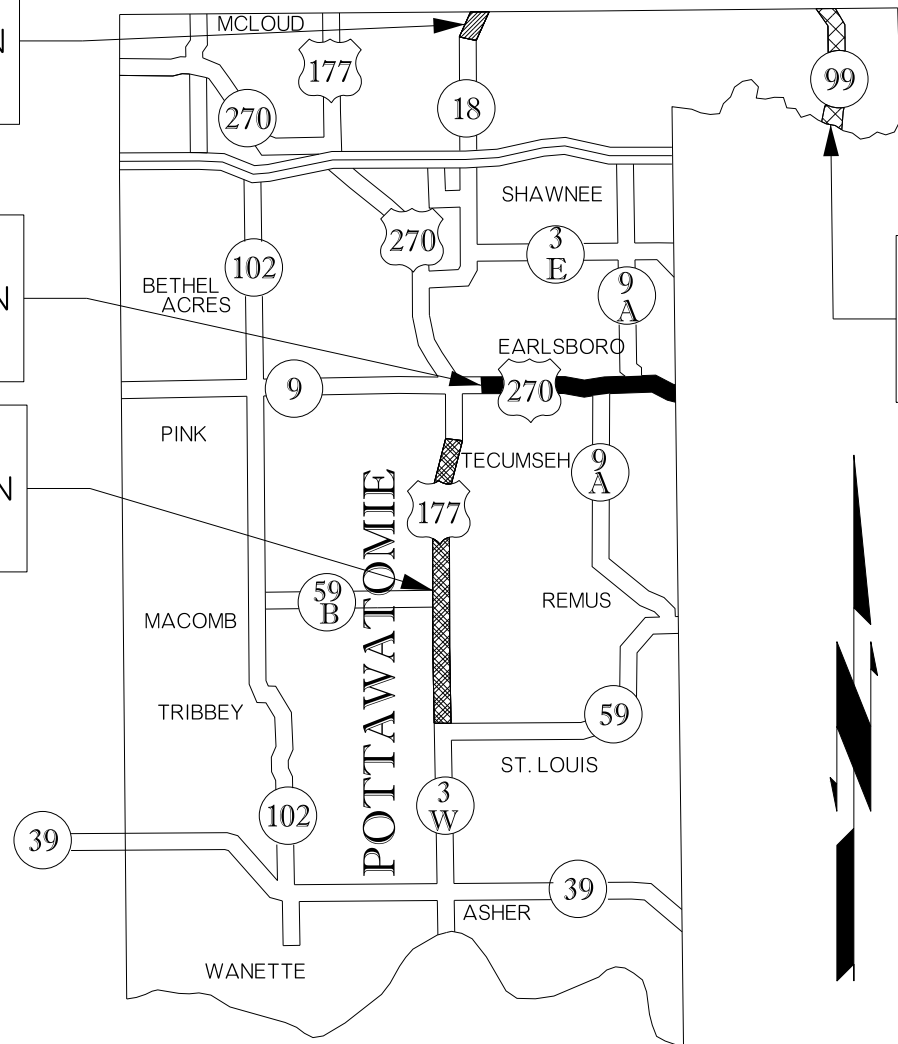

△ H  
CONTROL SECTION  
99-63-36

CONTROL SECTION: 270-63-12, 99-63-36, 18-63-26 & 177-63-20		
301 TRAFFIC STRIPING		
DESCRIPTION	UNIT	QUANTITY
RUMBLE STRIP-CENTERLINE HMA-CON	LF	125,460.00
TRAFFIC STRIPE (MULTI-POLYMER)(4" WIDE)	LF	250,920.00
PAVEMENT MARKING REMOVAL (TRAFFIC STRIPE)	LF	250,920.00

PROJECT DESCRIPTION  
LOCATION: G △

US-270: BEGINNING APPROXIMATELY 1.53 MILES EAST OF THE JUNCTION OF SH-9 AND US-270, IN THE CITY OF TECUMSEH, EXTENDING EAST APPROXIMATELY 6.71 MILES TO THE SEMINOLE COUNTY LINE, IN POTTAWATOMIE COUNTY.

PROJECT DESCRIPTION  
LOCATION: H △

SH-99: BEGINNING AT THE SEMINOLE COUNTY LINE EXTENDING NORTH APPROXIMATELY 4.43 MILES TO THE LINCOLN COUNTY LINE, IN POTTAWATOMIE COUNTY.

PROJECT DESCRIPTION  
LOCATION: I △

SH-18: BEGINNING APPROXIMATELY 4.50 MILE NORTH OF THE JUNCTION OF I-40 AND SH-18, IN THE CITY OF SHAWNEE, EXTENDING NORTH 1.04 MILES TO THE LINCOLN COUNTY LINE, IN POTTAWATOMIE COUNTY.

PROJECT DESCRIPTION  
LOCATION: J △

US-177: BEGINNING APPROXIMATELY AT THE JUNCTION OF SH-59 AND US-177, EXTENDING NORTH APPROXIMATELY 11.58 MILES TO THE CITY OF TECUMSEH, IN POTTAWATOMIE COUNTY.

KEY:

△ G:	
△ H:	
△ I:	
△ J:	

NOT TO SCALE

TOTAL LENGTH- 23.76 MILES

DIVISION 3 US-177 & 270/ SH-18 & 99	POTTAWATOMIE COUNTY	DETAIL:	TMS	7/17
PROJECT LOCATION POTTAWATOMIE COUNTY		CHECK:	GF	7/17
		ENGINEER:	KCD	7/17
STATE OF OKLAHOMA		DEPARTMENT OF TRANSPORTATION	JOB/PIECE NO. 33294(04)	
			SHEET NO. T005	

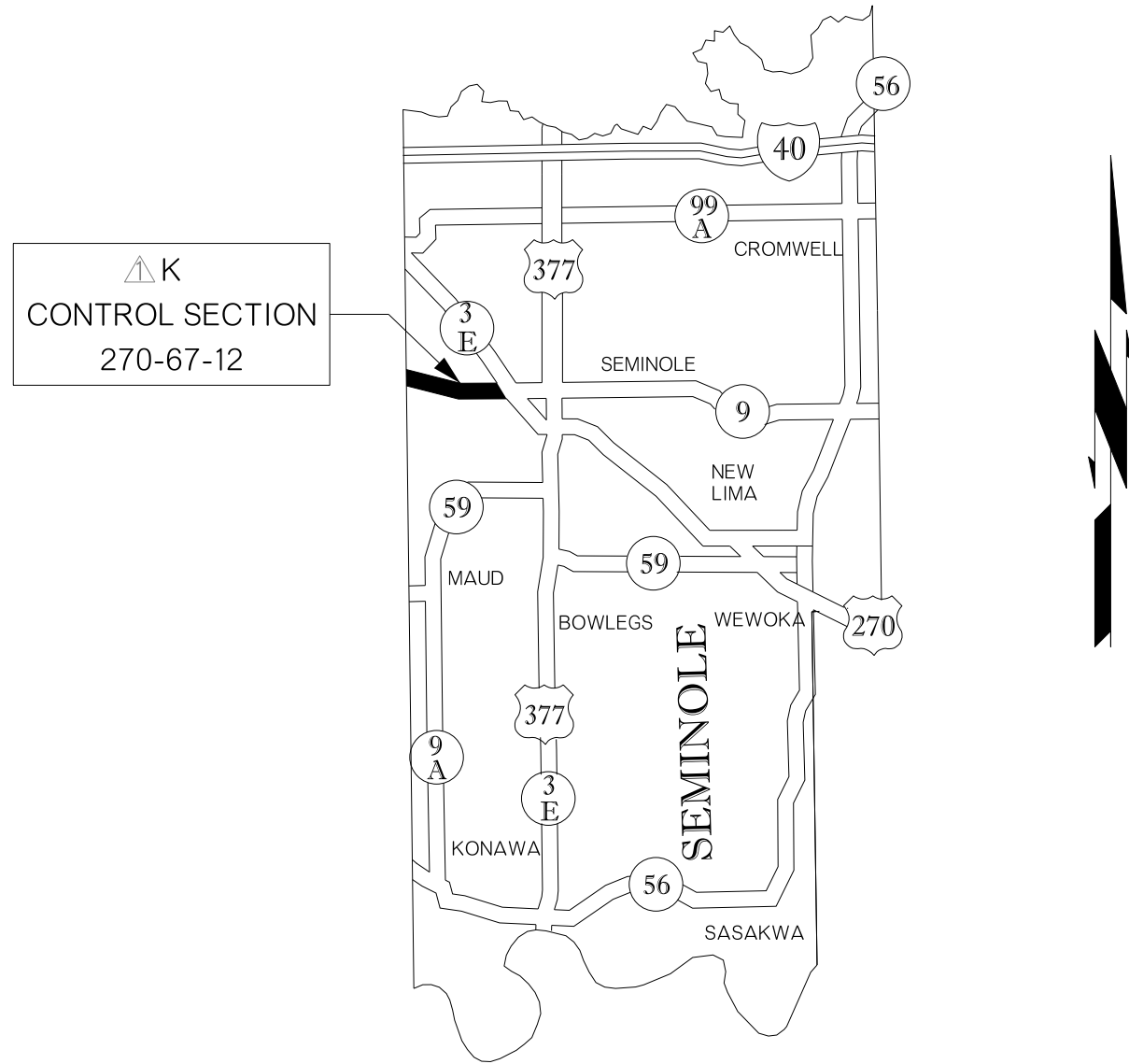

CONTROL SECTION: 270-67-12		
301 TRAFFIC STRIPING		
DESCRIPTION	UNIT	QUANTITY
RUMBLE STRIP-CENTERLINE HMA-CON	LF	20,100.00
TRAFFIC STRIPE (MULTI-POLYMER)(4" WIDE)	LF	40,200.00
PAVEMENT MARKING REMOVAL (TRAFFIC STRIPE)	LF	40,200.00

PROJECT DESCRIPTION      US-270: BEGINNING AT THE POTTAWATOMIE COUNTY LINE EXTENDING EAST  
 LOCATION: K      APPROXIMATELY 3.80 MILES TO THE CITY OF SEMINOLE, IN SEMINOLE COUNTY

TOTAL LENGTH: 3.80 MILES

KEY:  
 K: [Redacted]

NOT TO SCALE

DIVISION 3 US-270	SEMINOLE COUNTY	DETAIL:	TMS	7/17
PROJECT LOCATION SEMINOLE COUNTY		CHECK:	GF	7/17
		ENGINEER:	KCD	7/17
STATE OF OKLAHOMA		DEPARTMENT OF TRANSPORTATION		
JOB/PIECE NO. 33294(04)		SHEET NO. T006		



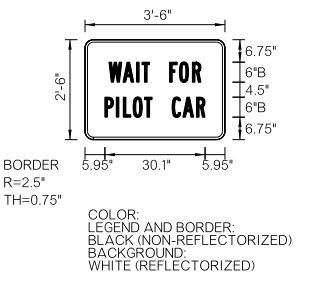
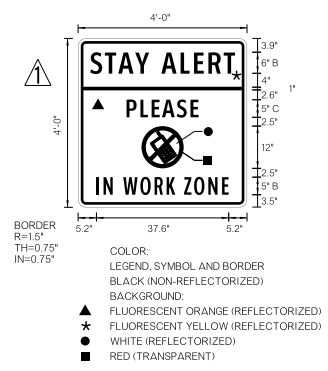

AADT	LANE CLOSURE LIMIT
<4,000	2 MILES
4,000- 9,000	1 MILE
>9,000	0.5 MILE

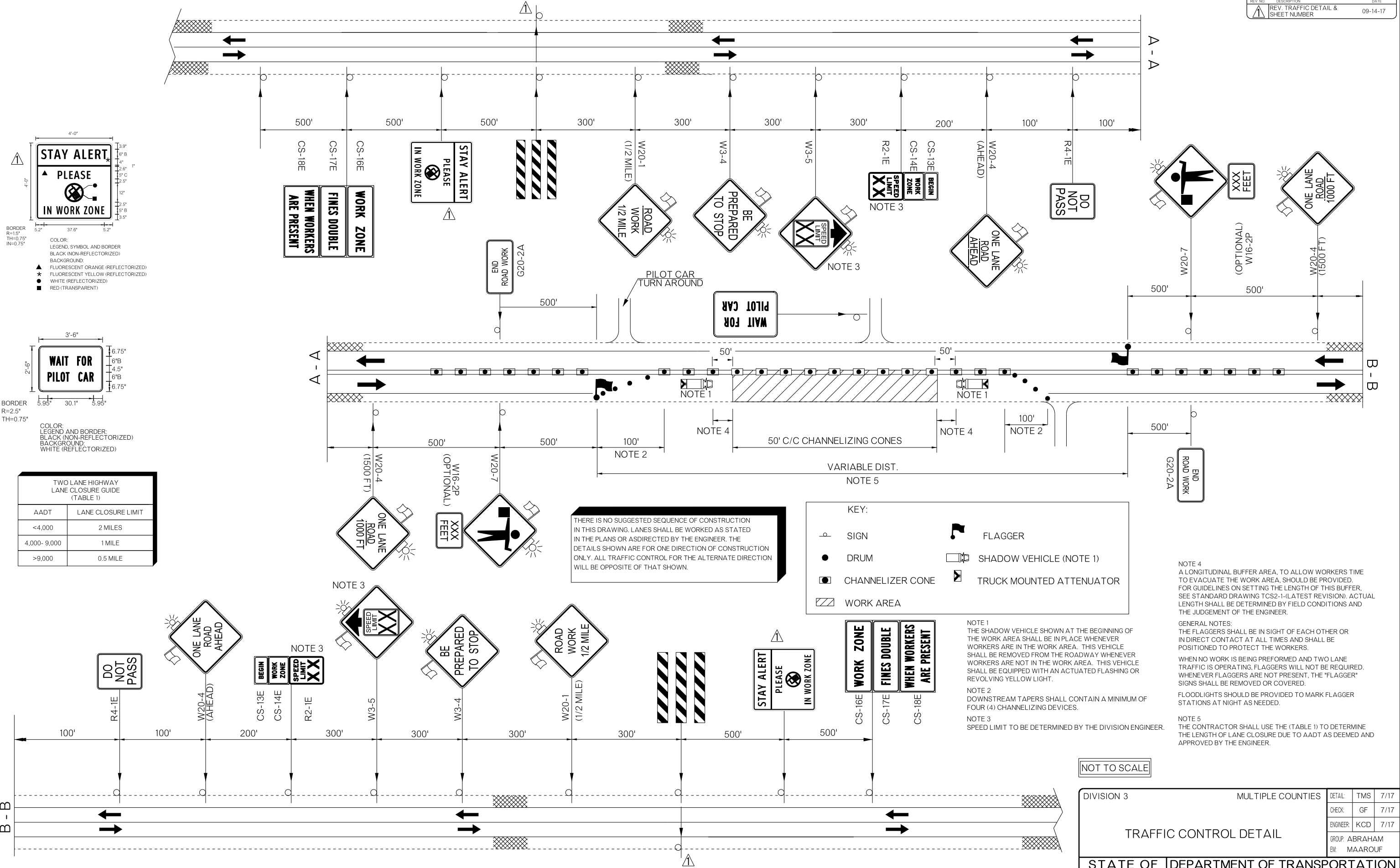

THERE IS NO SUGGESTED SEQUENCE OF CONSTRUCTION IN THIS DRAWING. LANES SHALL BE WORKED AS STATED IN THE PLANS OR AS DIRECTED BY THE ENGINEER. THE DETAILS SHOWN ARE FOR ONE DIRECTION OF CONSTRUCTION ONLY. ALL TRAFFIC CONTROL FOR THE ALTERNATE DIRECTION WILL BE OPPOSITE OF THAT SHOWN.

KEY:

- SIGN
- DRUM
- CHANNELIZER CONE
- ▨ WORK AREA
- 🚧 FLAGGER
- 🚚 SHADOW VEHICLE (NOTE 1)
- 🚚 TRUCK MOUNTED ATTENUATOR

- NOTE 1: THE SHADOW VEHICLE SHOWN AT THE BEGINNING OF THE WORK AREA SHALL BE IN PLACE WHENEVER WORKERS ARE IN THE WORK AREA. THIS VEHICLE SHALL BE REMOVED FROM THE ROADWAY WHENEVER WORKERS ARE NOT IN THE WORK AREA. THIS VEHICLE SHALL BE EQUIPPED WITH AN ACTUATED FLASHING OR REVOLVING YELLOW LIGHT.
- NOTE 2: DOWNSTREAM TAPERS SHALL CONTAIN A MINIMUM OF FOUR (4) CHANNELIZING DEVICES.
- NOTE 3: SPEED LIMIT TO BE DETERMINED BY THE DIVISION ENGINEER.
- NOTE 4: A LONGITUDINAL BUFFER AREA, TO ALLOW WORKERS TIME TO EVACUATE THE WORK AREA, SHOULD BE PROVIDED. FOR GUIDELINES ON SETTING THE LENGTH OF THIS BUFFER, SEE STANDARD DRAWING TCS2-1-(LATEST REVISION). ACTUAL LENGTH SHALL BE DETERMINED BY FIELD CONDITIONS AND THE JUDGEMENT OF THE ENGINEER.
- GENERAL NOTES:  
 THE FLAGGERS SHALL BE IN SIGHT OF EACH OTHER OR IN DIRECT CONTACT AT ALL TIMES AND SHALL BE POSITIONED TO PROTECT THE WORKERS.  
 WHEN NO WORK IS BEING PERFORMED AND TWO LANE TRAFFIC IS OPERATING, FLAGGERS WILL NOT BE REQUIRED. WHENEVER FLAGGERS ARE NOT PRESENT, THE 'FLAGGER' SIGNS SHALL BE REMOVED OR COVERED.  
 FLOODLIGHTS SHOULD BE PROVIDED TO MARK FLAGGER STATIONS AT NIGHT AS NEEDED.
- NOTE 5: THE CONTRACTOR SHALL USE THE (TABLE 1) TO DETERMINE THE LENGTH OF LANE CLOSURE DUE TO AADT AS DEEMED AND APPROVED BY THE ENGINEER.

NOT TO SCALE

DIVISION 3		MULTIPLE COUNTIES		DETAIL:	TMS	7/17
				CHECK:	GF	7/17
				ENGINEER:	KCD	7/17
				GROUP:	ABRAHAM	
				EM:	MAAROUF	

TRAFFIC CONTROL DETAIL

STATE OF OKLAHOMA DEPARTMENT OF TRANSPORTATION  
 JOBPIECE NO. 33294(04) SHEET NO. T007